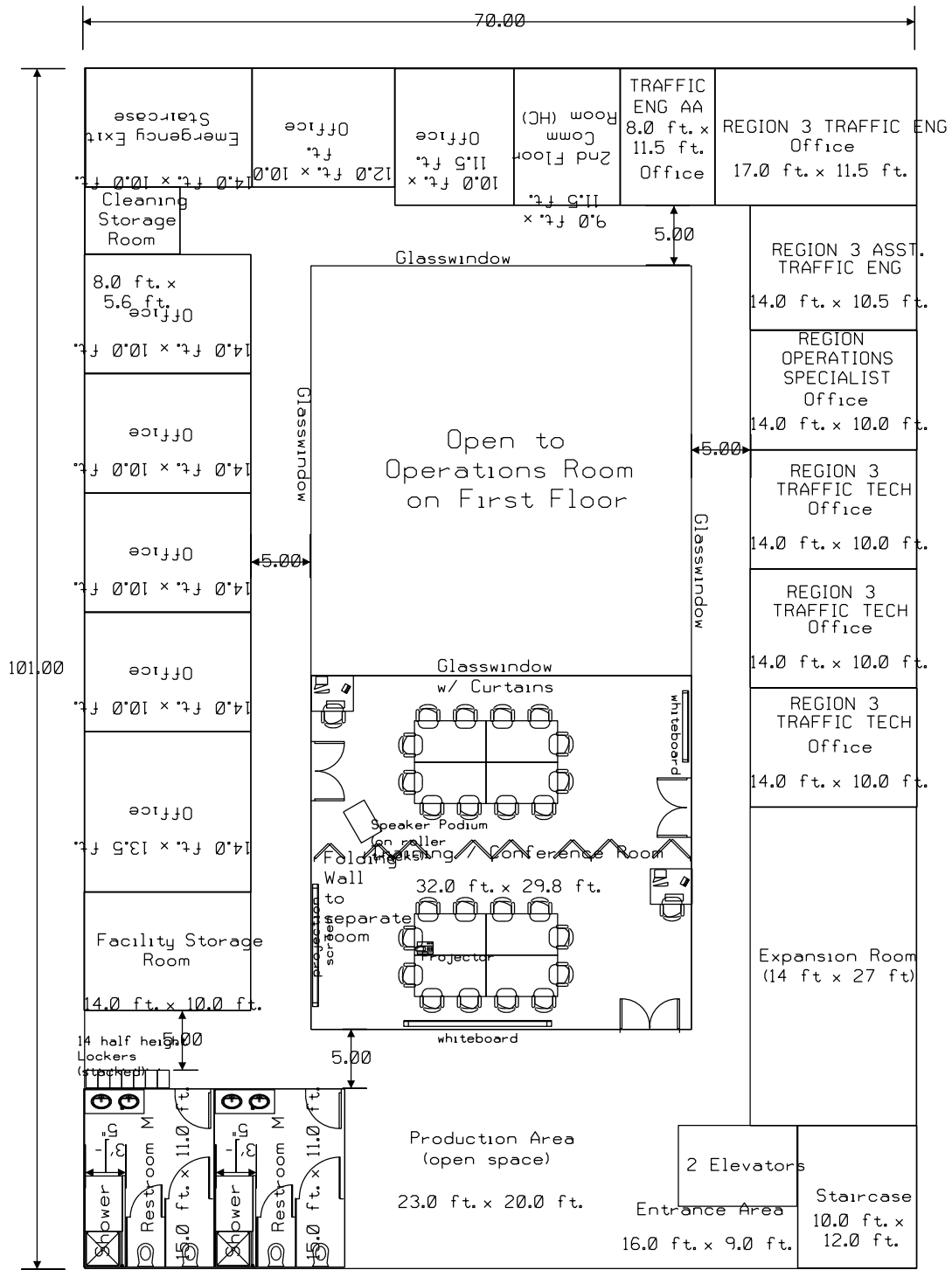

Figure 6-3: TDOT TMC Design - Final Layout (2nd Floor):  
 Conceptual Layout - Two-story solution

Size of both floors:  
 ~13,000 ft<sup>2</sup>



Notes:

- 1.) any training room should be organized to be as square as possible to ease interaction between instructors and instructees. A view into the Operations Room should be provided, since at least some of the training will be in respect to the RTMC.